

Daiwa Bw2 Manual

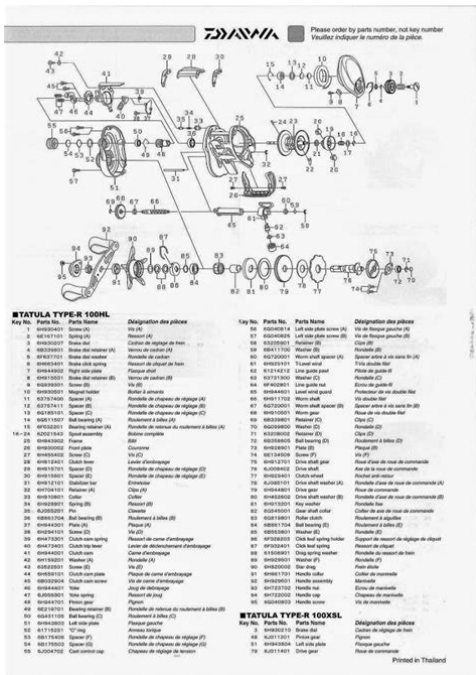

File Name: Daiwa Bw2 Manual.pdf

Size: 2878 KB

Type: PDF, ePub, eBook

Category: Book

Uploaded: 3 May 2019, 22:38 PM

Rating: 4.6/5 from 802 votes.

Status: AVAILABLE

Last checked: 4 Minutes ago!

In order to read or download Daiwa Bw2 Manual ebook, you need to create a FREE account.

Download Now!

eBook includes PDF, ePub and Kindle version

- [Register a free 1 month Trial Account.](#)
- [Download as many books as you like \(Personal use\)](#)
- [Cancel the membership at any time if not satisfied.](#)
- [Join Over 80000 Happy Readers](#)

Book Descriptions:

We have made it easy for you to find a PDF Ebooks without any digging. And by having access to our ebooks online or by storing it on your computer, you have convenient answers with Daiwa Bw2 Manual . To get started finding Daiwa Bw2 Manual , you are right to find our website which has a comprehensive collection of manuals listed.

Our library is the biggest of these that have literally hundreds of thousands of different products represented.



Book Descriptions:

Daiwa Bw2 Manual



This is the place to download a manual. Regards Geoff Press the ratchet ring down towards the star drag as you turn the handle backwards to unscrew it from the crank shaft. There should be a dial on the side which controls a magnet that keeps it from backlash make small adjustment and cast also use your thumb to aid in controlling the spool. Then practice practice practice. Peace, Shepp Login to post Daiwa, Abu Garcia, Shimano are popular fishing reel brands available in the market. All the product from these brand is durable and high quality and you can purchase from these brands. I have found a pair of an article about the best fishing rods and reels that you can check. Here is the articles Best Baitcasting Reels brand The handle turns backwards, and this is a reel that has antireverse. Other methods use a ratchet. Yumoshi fishing reel. Answer questions, earn points and help others. Featuring forwardthinking designs and components including hyperspeed ball bearings, carbon fiber handles and freefloating spools, Daiwa baitcasting and spinning reels are use by weekend warriors and professionals alike. Daiwa reels are designed to be easy to adjust and easy to use so more time can be spent fishing than making adjustments. Using a Daiwa spinning or bait casting reel can be done successfully by a wide range of anglers. Spinning Reel Check that Daiwa spinning reel to determine whether it is securely mounted to the reel seat of the spinning rod. Tighten the locking rings so the reel is held in place if necessary. Hold the Daiwa spinning reel and rod with your dominant hand. Grasp the handle of the rod so that your middle and ring finger split around the foot of the Daiwa reel. Wrap your fingers and thumb around the hand of the spinning reel. Rotate the bail wire of the Daiwa reel so that the line roller is located up or at the 12 o'clock position. Reach forward with the index finger of the hand holding the rod and hook the line just above the line roller. <http://www.aqualife.fi/userfiles/file/canon-sure-shot-telemax-manual.xml>

- **daiwa bw2 manual, daiwa bw2 reel manual, carretilha daiwa bw2 manual, daiwa bw2 manual, daiwa bw2 manual, daiwa bw2 manual, daiwa bw2 baitcaster manual, daiwa bw2 reel owner s manual.**

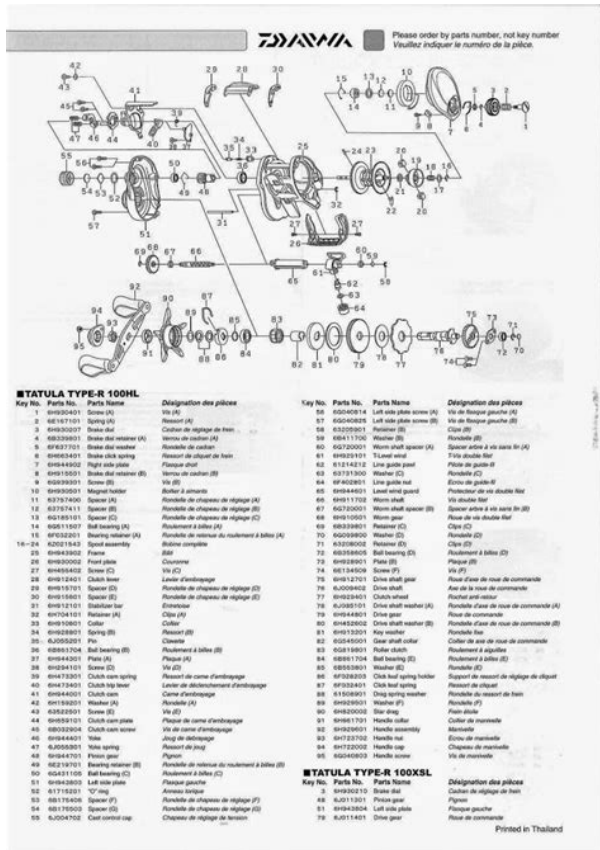

Grip the line with your finger and hold it in place. Open the bail of the Daiwa reel with your opposite hand and lock it back into place. Bring the rod back to the side and then forward toward the target on the water. Release the line as the tip of the rod approaches the direction of the target. Close the bail of the Daiwa spinning reel once the lure or bait is in the water by turning the reel handle. Continue turning the handle to retrieve the lure or bait through the water. Baitcast Reel Locate the brake adjustment dial on the side of the reel opposite the handle. Turn the dial to a setting that is in the middle between the Nos. 5 and 7. Hold the rod with your dominant hand. Grip the rod so that your index finger hooks around the trigger of the baitcast rod. Make sure your thumb can easily access the spool release button on the back of the reel. Locate the spool tension knob on the side of the reel beside the handle. Turn the knob so it is completely tightened. Extend the rod out in front of you and press the spool release. Turn the spool tension knob back to slowly decrease the tension. Stop turning the knob when the lure on the end of the line drops slowly to the ground. Stand and face the target on the water. Press the spool release on the back of the spool and maintain pressure on the line with your thumb. Turn the reel sideways so that the handle is facing down. Bring the rod tip back and then forward with a rapid motion. Raise your thumb to release the line as the rod tip approaches the direction of the target on the water. Tips Turning the reel to the side while casting will help to greatly reduce the possibility of backlash. By turning the reel, the forward and downward motion of the spool is reduced, preventing the fishing line from being pulled down into the line on the spool, resulting in a backlash. About the Author Keith Dooley has a degree in outdoor education and sports management. <http://www.fkhd.cz/data/canon-sure-shot-supreme-user-manual.xml>



He has worked as an assistant athletic director, head coach and assistant coach in various sports including football, softball and golf. Dooley has worked for various websites in the past, contributing instructional articles on a wide variety of topics. Auction is for a lightly used Daiwa BW2 Baitcasting reel. Features a HiSpeed 5.21 gear ratio with 2 Graphite bearings. This. more one is in perfect working order. With just a few light scuff marks on the outer casing as shown in photos. Has been serviced, oiled, and in Ready2Fish condition. If not satisfied upon receipt you may send back for a full refund. No stock images here. Make sure to ask any questions before bidding, and if you are ever unhappy upon item receipt contact me for resolution before leaving feedback. I strive for 100% customer satisfaction or will offer a full refund. Double your traffic. Get Vendio Gallery Now FREE. BRAND NEW High Quality Spool Ball Bearings Daiwa BW2. You are bidding on 2 High Quality ABEC5 or Higher Ball Bearings. This is an upgrade replacement for the factory fishing reel spool ball bearings. Offered in this auction is a set of two ball bearings to upgrade the factory bearings on your reel for a more refined fishing reel. Payment We only accept PayPal. PayPal is safe and fast for both buyer and seller. Standard First Class Mail Shipping Service Tracking Number 12 business days to process. 2 9 days to reach in the 48 contiguous states. 2 If you request faster delivery. Your item will be carefully packed then Shipped directly to you by U.S Postal Service International Airmail. Standard Intl Mail Flat Rate Shipping Service No Tracking Number 12 business days to process. Min. 1014 business days to reach. Varies by destination, and custom clearance delays. 2 If you request tracking number or faster delivery. Please make sure your address in Ebay matches with your Shipping address before you pay. We are not responsible for any applicable customs charge. Taxes and duties.

Return Policy 1 If for any reason you're not happy Auction is for a lightly used Daiwa BW2 Baitcasting reel. Make sure to ask any questions before bidding, and if you are ever unhappy upon item receipt contact me for resolution before leaving feedback. I strive for 100% customer satisfaction or will offer a full refund. Handle is on the. more right side of the reel. SHIPPING Outside of the Continental 48 States or to PO Box. Colorado Residents must pay sales tax if picked up or shipped. NonResidents also pay local sales tax for pickups. Payment through PAYPAL or pickup in person only. Thank you. Pay me securely with any major credit card through PayPal! Handle is on the right side of the reel. Payment through PAYPAL or pickup in person only. Thank you. Pay me

securely with any major credit card through PayPal! Would work well for a beginner. Thanks for looking Some signs of use, ready to work the big ones this season. Buy 3 at once to save on shipping and get your tackle box ready for the season. No other international shipping. Please ask all questions before bidding. Thanks for looking. See my other auctions. Posted with clumsy fingers and Flintstone keyboard. Good condition, gently used. Made in Japan Daiwa BW2 Flipping Graphite bearing Baitcaster. And the Abu Garcia Maxar Cardinal Spin caster reel. The Abu Garcia is missing the rear cover, see Photo 4, still works. Both are previously well used so condition reflects that! Please check out my other auctions for more new and used hard to find reel parts and reels. Shipping is by USPS Priority Mail. Thanks for looking! Powered by The free listing tool. List your items fast and easy and manage your active items. In excellent working condition. No damage. Smooth reel. I will answer any questions that I can. Thanks for looking and have a great day. Check out my! Be sure to add me to your. I do my best to answer questions within 48 hours.



<http://dev.pb-adcon.de/node/15307>

NO INTERNATIONAL SHIPPING I will always combine shipping whenever possible except when to do so may cause damage to items. Its in very good cosmetic and functional shape. The frame. Plates and seat are all in very good shape with some surface wear and the graphics are still looking good. The st and. Star and crank very good shape as well with some normal wear. Spool looks very good with some lite wear. Normal finish wear and very good cosmetic shape in all. The SuperSized and ZoomAble pictures are of the reel which show it quite well. This Daiwa BW2 is still in very good working shape. It cranks well with good anti reverse and the gears feel good on crank. The drag works well an d f reespool works well and it has magnetic and manual adjuster. Clutch works well and kicks out of gear on crank. Also. more has a forwardreverse mode with a well working switch and sports a speedy 5.21 gear ratio. Also has a well working flipping switch. Some normal finish wear but sti ll a very good looking and working reel. International bidders are welcome and we offer International Priority which comes with Insurance to cover both parties for any damages and loss during shipment. Shipping in the USA is Priority with DC. If you have any questions before placing your winning bid please drop me a line and I will get back to you as soon as I can. Thanks for taking the time to view my auction. 336.RcmdId ViewItemDescV4,RlogId p4%60bo7%60jtb9%3Fvo%7B%3Dd70f%2B%3E3361402898a9d60x105 Reels are used. But is god overall condition. Please take a good look at the photos to get a good idea of the condition. All of the reels also work good, except the Quantum reel. It works, but reels very tight. It is missing the side knob, so this can probably be adjusted to reel better. Daiwa BW2 HiSpeed reel. Made in Japan. In excellent condition. Shamino Bantam Crestfire CR200A. Made in Malaysia. Mitchell X200 high performance 2 ball bearings. Quantum Tournament Grade TG400CX. 4 bearings.

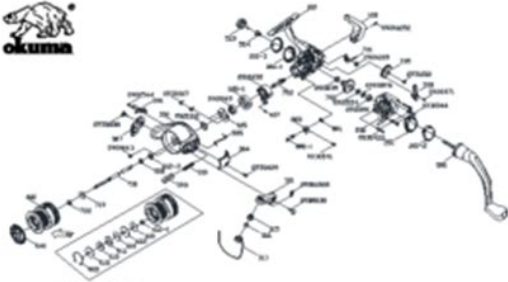

72-90 PARTS LIST

KEY NO.	PARTS NO.	PARTS NAME	KEY NO.	PARTS NO.	PARTS NAME
800	000000	MAIN BODY	801	000000	KEY WASHER
801	000001	FRONT BRASS/STEEL RING	802	000001	REAR GRAS
802	000002	FRONT BRASS/STEEL PLATE	803	000002	REAR GRAS
803	000003	CAP	804	000003	FRONT/REAR GRAS
804	000004	REAR GRAS	805	000004	FRONT/REAR GRAS
805	000005	REAR PLATE DECORATION	806	000005	FRONT/REAR GRAS
806	000006	FRONT PLATE DECORATION	807	000006	FRONT/REAR GRAS
807	000007	FRONT PLATE DECORATION	808	000007	FRONT/REAR GRAS
808	000008	FRONT PLATE DECORATION	809	000008	FRONT/REAR GRAS
809	000009	FRONT PLATE DECORATION	810	000009	FRONT/REAR GRAS
810	000010	FRONT PLATE DECORATION	811	000010	FRONT/REAR GRAS
811	000011	FRONT PLATE DECORATION	812	000011	FRONT/REAR GRAS
812	000012	FRONT PLATE DECORATION	813	000012	FRONT/REAR GRAS
813	000013	FRONT PLATE DECORATION	814	000013	FRONT/REAR GRAS
814	000014	FRONT PLATE DECORATION	815	000014	FRONT/REAR GRAS
815	000015	FRONT PLATE DECORATION	816	000015	FRONT/REAR GRAS
816	000016	FRONT PLATE DECORATION	817	000016	FRONT/REAR GRAS
817	000017	FRONT PLATE DECORATION	818	000017	FRONT/REAR GRAS
818	000018	FRONT PLATE DECORATION	819	000018	FRONT/REAR GRAS
819	000019	FRONT PLATE DECORATION	820	000019	FRONT/REAR GRAS
820	000020	FRONT PLATE DECORATION	821	000020	FRONT/REAR GRAS
821	000021	FRONT PLATE DECORATION	822	000021	FRONT/REAR GRAS
822	000022	FRONT PLATE DECORATION	823	000022	FRONT/REAR GRAS
823	000023	FRONT PLATE DECORATION	824	000023	FRONT/REAR GRAS
824	000024	FRONT PLATE DECORATION	825	000024	FRONT/REAR GRAS
825	000025	FRONT PLATE DECORATION	826	000025	FRONT/REAR GRAS
826	000026	FRONT PLATE DECORATION	827	000026	FRONT/REAR GRAS
827	000027	FRONT PLATE DECORATION	828	000027	FRONT/REAR GRAS
828	000028	FRONT PLATE DECORATION	829	000028	FRONT/REAR GRAS
829	000029	FRONT PLATE DECORATION	830	000029	FRONT/REAR GRAS
830	000030	FRONT PLATE DECORATION	831	000030	FRONT/REAR GRAS
831	000031	FRONT PLATE DECORATION	832	000031	FRONT/REAR GRAS
832	000032	FRONT PLATE DECORATION	833	000032	FRONT/REAR GRAS
833	000033	FRONT PLATE DECORATION	834	000033	FRONT/REAR GRAS
834	000034	FRONT PLATE DECORATION	835	000034	FRONT/REAR GRAS
835	000035	FRONT PLATE DECORATION	836	000035	FRONT/REAR GRAS
836	000036	FRONT PLATE DECORATION	837	000036	FRONT/REAR GRAS
837	000037	FRONT PLATE DECORATION	838	000037	FRONT/REAR GRAS
838	000038	FRONT PLATE DECORATION	839	000038	FRONT/REAR GRAS
839	000039	FRONT PLATE DECORATION	840	000039	FRONT/REAR GRAS
840	000040	FRONT PLATE DECORATION	841	000040	FRONT/REAR GRAS
841	000041	FRONT PLATE DECORATION	842	000041	FRONT/REAR GRAS
842	000042	FRONT PLATE DECORATION	843	000042	FRONT/REAR GRAS
843	000043	FRONT PLATE DECORATION	844	000043	FRONT/REAR GRAS
844	000044	FRONT PLATE DECORATION	845	000044	FRONT/REAR GRAS
845	000045	FRONT PLATE DECORATION	846	000045	FRONT/REAR GRAS
846	000046	FRONT PLATE DECORATION	847	000046	FRONT/REAR GRAS
847	000047	FRONT PLATE DECORATION	848	000047	FRONT/REAR GRAS
848	000048	FRONT PLATE DECORATION	849	000048	FRONT/REAR GRAS
849	000049	FRONT PLATE DECORATION	850	000049	FRONT/REAR GRAS
850	000050	FRONT PLATE DECORATION	851	000050	FRONT/REAR GRAS
851	000051	FRONT PLATE DECORATION	852	000051	FRONT/REAR GRAS
852	000052	FRONT PLATE DECORATION	853	000052	FRONT/REAR GRAS
853	000053	FRONT PLATE DECORATION	854	000053	FRONT/REAR GRAS
854	000054	FRONT PLATE DECORATION	855	000054	FRONT/REAR GRAS
855	000055	FRONT PLATE DECORATION	856	000055	FRONT/REAR GRAS
856	000056	FRONT PLATE DECORATION	857	000056	FRONT/REAR GRAS
857	000057	FRONT PLATE DECORATION	858	000057	FRONT/REAR GRAS
858	000058	FRONT PLATE DECORATION	859	000058	FRONT/REAR GRAS
859	000059	FRONT PLATE DECORATION	860	000059	FRONT/REAR GRAS
860	000060	FRONT PLATE DECORATION	861	000060	FRONT/REAR GRAS
861	000061	FRONT PLATE DECORATION	862	000061	FRONT/REAR GRAS
862	000062	FRONT PLATE DECORATION	863	000062	FRONT/REAR GRAS
863	000063	FRONT PLATE DECORATION	864	000063	FRONT/REAR GRAS
864	000064	FRONT PLATE DECORATION	865	000064	FRONT/REAR GRAS
865	000065	FRONT PLATE DECORATION	866	000065	FRONT/REAR GRAS
866	000066	FRONT PLATE DECORATION	867	000066	FRONT/REAR GRAS
867	000067	FRONT PLATE DECORATION	868	000067	FRONT/REAR GRAS
868	000068	FRONT PLATE DECORATION	869	000068	FRONT/REAR GRAS
869	000069	FRONT PLATE DECORATION	870	000069	FRONT/REAR GRAS
870	000070	FRONT PLATE DECORATION	871	000070	FRONT/REAR GRAS
871	000071	FRONT PLATE DECORATION	872	000071	FRONT/REAR GRAS
872	000072	FRONT PLATE DECORATION	873	000072	FRONT/REAR GRAS
873	000073	FRONT PLATE DECORATION	874	000073	FRONT/REAR GRAS
874	000074	FRONT PLATE DECORATION	875	000074	FRONT/REAR GRAS
875	000075	FRONT PLATE DECORATION	876	000075	FRONT/REAR GRAS
876	000076	FRONT PLATE DECORATION	877	000076	FRONT/REAR GRAS
877	000077	FRONT PLATE DECORATION	878	000077	FRONT/REAR GRAS
878	000078	FRONT PLATE DECORATION	879	000078	FRONT/REAR GRAS
879	000079	FRONT PLATE DECORATION	880	000079	FRONT/REAR GRAS
880	000080	FRONT PLATE DECORATION	881	000080	FRONT/REAR GRAS
881	000081	FRONT PLATE DECORATION	882	000081	FRONT/REAR GRAS
882	000082	FRONT PLATE DECORATION	883	000082	FRONT/REAR GRAS
883	000083	FRONT PLATE DECORATION	884	000083	FRONT/REAR GRAS
884	000084	FRONT PLATE DECORATION	885	000084	FRONT/REAR GRAS
885	000085	FRONT PLATE DECORATION	886	000085	FRONT/REAR GRAS
886	000086	FRONT PLATE DECORATION	887	000086	FRONT/REAR GRAS
887	000087	FRONT PLATE DECORATION	888	000087	FRONT/REAR GRAS
888	000088	FRONT PLATE DECORATION	889	000088	FRONT/REAR GRAS
889	000089	FRONT PLATE DECORATION	890	000089	FRONT/REAR GRAS
890	000090	FRONT PLATE DECORATION	891	000090	FRONT/REAR GRAS
891	000091	FRONT PLATE DECORATION	892	000091	FRONT/REAR GRAS
892	000092	FRONT PLATE DECORATION	893	000092	FRONT/REAR GRAS
893	000093	FRONT PLATE DECORATION	894	000093	FRONT/REAR GRAS
894	000094	FRONT PLATE DECORATION	895	000094	FRONT/REAR GRAS
895	000095	FRONT PLATE DECORATION	896	000095	FRONT/REAR GRAS
896	000096	FRONT PLATE DECORATION	897	000096	FRONT/REAR GRAS
897	000097	FRONT PLATE DECORATION	898	000097	FRONT/REAR GRAS
898	000098	FRONT PLATE DECORATION	899	000098	FRONT/REAR GRAS
899	000099	FRONT PLATE DECORATION	900	000099	FRONT/REAR GRAS

We are not experts on the inner components. And base the working condition by what we can check from the outside. We do our best to describe any problems the reel may have. Delivery confirmation included in shipping and handling cost. We also will combine shipping to save the buyer. more money. If interested in more then one of our items. Please let us know, and we can come up with a price. All of our auction have no reserves. We do our best to describe the condition of the items we sell. If the buyer is not happy for any reason. We will go out of way to make them happy. We strive to earn 5 star ratings. We often get new rods and reels in. If you are looking for something in particular. Please let us know. A LITTLE ABOUT US AND OUR MISSION. Fishing for Life is a nonprofit Christian fund raising group working to support urban youth ministries in Minneapolis and St. Paul. Fishing For Life is a nonprofit organization dedicated to serving youth through various fishing programs. In 2008 we were selected by the National Parks and Recreation Association to serve as one of 30 "ANCHOR AGENCIES" in the U.S. dedicated to promote and engage youth in the fishing and boating activities. Fishing For Life collects rods and reels throughout the year. The majority of these rods are restored during our annual rebuilding day and given to youth at our lake events or to organizations needing fishing equipment. In some instances equipment is sold online and these funds are u I will be glad to combine like auctions to save you money on postage. Check out my! Please make sure all your items are on the invoice before you pay. I can't combine after payment is made. Payment is due within 2 days unless bidding on more, please send a email. 336.RcmdId ViewItemDescV4,RlogId p4%60bo7%60jtb9%3Fvo%7B%3Dd70f%2B%3E33614321841a620x105 Please make sure all your items are on the invoice before you pay. Payment is due within 2 days unless bidding on more, please send a email. Mitchell 6630Z.



Used Condition. All reels working. Some reels have boat rash. Reels need cleaning. Please look at pictures and ask questions before bidding. Will combine shipping I try my best to describe every item I sell. If you feel I have not done so PLEASE contact me to see what we can work out SHIPPING METHOD ALL Shipments sent by US Postal Service USA Shipments Sent with Delivery Confirmation and USPS Online tracking of receipt We offer UPS Shipping as an option for heavier items must ship to a street address. No PO Boxes We offer combined. Please wait for us to send the invoice to get the discounted rate INTERNATIONAL SHIPPING INFO Available on this item ALL Shipments sent by US Postal Service Please wait for your invoice as the rate calculator is not always right and if you pay before you get your invoice. You may pay more than needed for shipping Import duties. Taxes and charges are not included in the item price or shipping charges. All items paid for on one invoice. I frequent the s. calif. coast, bajasea of cortez, and offshore san diego as. I usually check my computer 2x a day, you are important to me Also I only ship to the US. Please contact me if you have less than 10 feedback With Autocast. Very good condition. Please rely on photos for further details and condition. They are for parts only. Auction is for a lightly used Daiwa BW2 Baitcasting reel. Features a HiSpeed 5.21 gear ratio with 2 Graphite bearings. This one is in perfect working order. Make sure to ask any questions before bidding, and if you are ever unhappy upon item receipt contact me for resolution before leaving feedback. nbsp I strive for 100% customer satisfaction or will offer a full refund. Appears not to have been used very much. some surface marks. But not bad. Please check out the pictures. Fast 5.2 to 1 retrieve, Flipping and Direct Drive selectors, Precisionmachined bronze gears, Fast spool change, Autocast, with 2 graphite bearings and graphite unitized frame. Any questions or more pictures.

Please ask. Winner to pay shipping and I only ship within the U.S. Thank you for looking. RcmdId ViewItemDescV4,RlogId p4%60bo7%60jtb9%3Feog4d72f%2Bf7%60%3E144a728d4160x10e This reel works good. This reel holds 170 yds. of 10 lb. line or 150 yds. of 12 lb. line. Very light with a graphite unitized frame and 2 graphite bearings. Therefore, should you have any questions, please email me prior to bidding. All items are described as accurately as possible and conditions are never omitted intentionally. Please email with appropriate questions before you bid. Shipped from a smoke free environment. Confirmation is expected within two days and full payment expected within 5 days of auctions close. Items. more are usually shipped the next business day after payment is received.

Different items added all the time! Made in Japan. In Good Condition! Estate tackle box find. This is a really nice smooth reel. 10lb or 12lb line works good for this reel. Please look at the pictures in super size. Any questions email me. This reel could be fished as soon as you receive it. But I would give it a minor cleaning and new line. Made in Japan. Reels show some wear. Such as boat rash, but nothing out of the ordinary. Tge PMA 33 looks to missing the small logo plate on one side. Some reels show more wear then others. Reels also works good. The parts seem to function. They do make small amount of noise when reeling. I would guess they just need some oil and cleaning. The PMA33 also has a smallhitch when reeling. Procaster PMA33Magforce MA 15GMagforce MA10GBW2 We are not experts on the inner components of the reels and base the condition on the exterior. Fishing for Life is a nonprofit Christian fund raising group working to support urban youth ministries in Minneapolis and St. Paul. We are a nonprofit organization dedicated to serving youth through. We often sell items on Ebay to raise more money to provide kids with new rods and reels.

<http://lisahyatthealth.com/wp-content/plugins/formcraft/file-upload/server/content/files/1628aef5461824---Canon-pc1059-manual.pdf>

Delivery confirmation is included in shipping and handling cost. We do combine shipping to save the buyer money. Please take a look at our other rods and reels. We do ship worldwide. Please understand that there is a bigger risk shipping international. We have no responsibility for lost packages once we send out. Please ask any questions you may have. And we will do our best to answer them in a timely manner. We strive to make the buyer happy. If there is a problem on our end. We will go out of our way to make everyone satisfied. Thank you for looking and good luck bidding! This Daiwa BW2 flipping reel is in great used condition and is running well. It has a high speed ratio of 5.21 with ball bearing construction. It has a few light marks. But all the decals are nice and vibrant, and completely legible. This reel is a nice model in that it'll go from a casting reel to a flipping reel with the push of a button. Mechanically it feels good and solid. The gears mesh as you'd expect from a quality Daiwa reel. The clutch is nice. Engages smoothly and with authority, and the drag system is working fine. The flipping function is works fine too. Please take a look at the pictures for condition and in case I missed or forgot to mention something. Don't hesitate to ask questions or for more pictures. I'm happy to help. But maybe not the best photographer.. more For some reason the camera flash made some of the pictures look a little more red, so I tried to include pictures both ways. Unfortunately, I needed to use the flash to show more detail. This is a quality reel at a tiny price. And with its dual uses both as a casting and flipping reel, you NEED to add it to your arsenal. So good luck and happy bidding. You pay what I pay for shipping. I do not mark it up to make a profit. There is a very small included fee that offsets the cost of boxes. Envelopes, bubble wrap, tape, etc. I am not an expert with most of the items I sell.

But I try to describe items accurately and to the best of my ability. If you have any questions, feel Ive left something out, or am just plain wrong, please dont hesitate to ask before you bid. Buyers with fewer than 5 transactions please contact me before bidding. At this time I only accept payment by PayPal. But I try very hard to ship by the next business day after receiving payment. If for some unlikely reason I can't, I will let you know immediately. I want you to be happy with your item. Yo If wanting to send alternate payment. Please make arrangements prior to bidding. **PAYMENT INFORMATION** Items must be paid for within 24 hours of purchasing item unless other arrangements are made prior to the end of the auction. Shipping Charges consist of Mailing Fees.No Shipping Discounts available for multiple purchases via International Shipping Program. All Items must be paid for and shipped separately due to EBAY's program restraint. If you are interested in items not listed. Please email me and if available, I will list the item. I will send an email with the item number to you if I have the item and am able to list it. If I do not answer your email within 24 hours. I do not have the item. Powered by The free listing tool. List your items fast and easy and manage your active items. They have some wear marks on 3 of them and one of the BW2s is like

new. One of the BW2s makes a little noise when reeling but only needs to be cleaned and lubed to make it work like new. 2 of the BW2s are grey in color and the other one is green in color. Gear ratios are 5.21 2 ball bearings All 4 reels are lightweight because they have graphite frames All were made and engineered in Japan Someone is going to get 4 great reels for a great price. Good luck! I only ship to the continental U.S. I accept Paypal. P018 Up for consideration is a Daiwa BW2 baitcasting reel made in Japan. This is a nice reel that functions properly with all operations checked.

The reel presents very well with vivid graphics on a gray finish. The reel appears to have seen some light use so there is a little wear to the graphics on the left side cover and a few scratches on the upper surfaces of the reel. Despite the cosmetic concerns. This is a nice older reel that is suitable for fishing or adding to a vintage tackle collection. Options NA Serial Number NA Age 1990s Country of Origin Japan Reel Grading Grade Appearance Grade Mechanical Condition A8 Very good used condition. Occasional light. more scratch; minor. Normal plating wear; rubber edges may not be sharp; minor foot imperfections; clean; crank knobs tight. M10 Excellent. All functions work perfectly; no wear. Concerns Light scratches on the upper surfaces of the reel. Wear to the graphics on the left side cover. None Factory Packaging NA Please wait for invoice prior to making payment. Shipping costs may be adjusted to reduce overall cost. I DO NOT SHIP TO BRAZIL OR ARGENTINA. SEE NOTES. TERMS AND CONDITIONS N, Shipping All items ship from Oregon City Oregon 97045. Seller charges actual postage. Most items ship via Priority mail. Seller will ship via economy upon request. Priority mail is recommended for reliability purposes. All items generally ship within 24 hrs. If postage rates are over estimated cost. The difference is absorbed by seller. Shipping overcharges will be refunded to buyer. For larger items. Seller may charge a nominal fee for packaging materials as noted in listing. Combined shipping is welcome. Seller will not falsify price or mark merchandise as a Gift to avoid taxes on international packages. This is against eBay policy and may be reported. Seller understands that the postage rate is som Right handed the reel is in great shape nice and smooth. With one of the largest collections of fishing reel schematics available, you're sure to find the part you're looking for. Submit your guide or outfitter service today! Equipped with on off flipping switch.

Condition is Used. Shipped with USPS First Class Package. I have more reels to list and a lot of new parts so if you're into reel repair put me on your favorite seller list. We greatly appreciate your positive feedback. If you have any issues at all, please contact us directly and we'll be happy to correct. Thank you for your business. Please check back with us often as we're adding hundreds of items every day. PLEASE check my other listings. DUE TO MY POST OFFICE HOUR CHANGE, YOU NOW HAVE TO HAVE YOUR ITEMS PAID BY 10.30 A.M. CENTRAL DAYLIGHT. more TIME TO GET SHIPMENT ON FRIDAY OTHERWISE I WILL SHIP THE FOLLOWING MONDAY. This reel is mechanically sound. Look at my feedback. Bid with confidence. Buyer pays shipping, which varies by zip code. Prompt shipment with payment by PayPal. Breakable items will be shipped Priority Mail. Thank you for bidding. If you are not COMPLETELY SATISFIED please contact me first before leaving NEGATIVE FEEDBACK. We strive to maintain a good customer buying experience and good Positive Feedback Rating. Please leave feedback responsibly. It is your responsibility to look at all the pictures and description provided before bidding. Auctiva gets you noticed. The complete eBay Selling Solution. Track Page Views With Auctiva's FREE Counter Condition is Used. Could use a good cleaning as well. Please check out the pics to verify condition and details. Thanks for looking and please check out my store for more great vintage collectibles. Policies Payment is due within 5 days of the end of the auction. If for some reason you cannot meet this requirement please contact me to explain why not. I do not ship outside of the continental United States. I will not ship for free.. more There are no discounts for buying multiple items, as the items are already priced as low as I can go on them. I will combine shipping charges for multiple item purchases. We ship Monday Friday excluding Thursday.

Your item will be shipped out as soon as we have a box for it and can get it packaged up. Items will be shipped out UPS Ground or USPS Priority mail, whichever is cheapest and I will list the tracking number on ebay so you can track your item. There are absolutely NO RETURNS!! I will be happy to leave positive feedback for you if you do the same for me once you receive your item. Thanks for looking!! Payment I only accept Paypal. Please make a payment by Paypal within 5 days after your purchase. Shipping Free shipping! We will ship to world wide by Economy International Shipping. We will ship your item within 10 business days, after your payment. We can ship ONLY to your Paypal address. International Buyers Please Note Import duties, taxes, and charges are not included in the item price. These charges are the buyers responsibility. Please check with your countrys customs office to determine what these additional costs will be prior to bidding or buying. Feeling, I do not feel, there are accessories such as boxes. Payment I only accept Paypal. Please make a payment by Paypal within 5 days after your purchase. Shipping Free shipping! We will. more ship to world wide by Economy International Shipping. We will ship your item within 10 business days, after your payment. We can ship ONLY to your Paypal address. International Buyers Please Note Import duties, taxes, and charges are not included in the item price or shipping cost. These charges are the buyers responsibility. Please check with your countrys customs office to determine what these additional costs will be prior to bidding or buying. We are located in Japan. Please feel free to ask any questions. We are selling items also in Japan, so contact us before your purchase if you dont want our order canceling because of stock shortage. We refund soon if the item is out of stock. Payment We accept PayPal only. Shipping We have two shipping methods as follows. Standard Duration 13 weeks Free Shipping!

Expedited Duration 37 days Not free for items under 200 USD Please Note Import duties, . more taxes, and charges are not included in the item price. Please check with your countrys customs office to determine what these additional costs will be prior to buying. We dont mark merchandise values below value or mark items as "gifts" Have a good shopping! Shipping Will usually ship within 5 business days of receiving cleared payment Other International Buyers Please Note Import duties taxes and charges are not included in the item price or shipping charges. These charges are the buyers responsibility. Please check with your countrys customs office to determine what. High Capsules Body Structure Resulting In Waterproof Performance, Dejigiya Ii By Precision Machine Cutting, Stable And Smooth Effectiveness Tournament. In The Fresh Water Bus And Trout, In The Sea To Widely Active From Bait Fishing In The Embankment And Shore To Lure Fishing. Payment We accept PayPal only. We will ship within 7 business days once payment is received. Shipping We accept PayPal only. We will ship within 7 business days once payment is received. Shipping 1. Economy Shipping Sal Registered AIR Small Mail About 27 weeks no Tracking Number 2. Standard Shipping E Packet Registered AIR Small Mail About 730 days with Tracking Number 3. Expedited Shipping EMS or DHL Service EMS Express Mail Service About 57 days with Tracking Number and full insurance DHL Service About 46 days with Tracking Number and full insurance However this may vary depending on destinations and other factors. About Us Thank you for visiting. We will provide you high quality products from Japan. Our commitment is to serve our customers with cordiality. We will make your shopping experience a great one. Please feel free to email us if you have any questions. We are waiting for your order. We usually ship within 5 business days of receiving cleared payment. Our return policy, In the only case of unopened item package. We ships from Japan This product.

Import duties, taxes, and charges are not. Payment I only accept Paypal. Please make a payment by Paypal within. Shipping Free shipping! We will ship to world wide by Economy International Shipping. We will ship your item within 10 business days, after your payment. We can ship ONLY to your Paypal address. Please check with your countrys customs office to determine what these additional costs will be prior to bidding or buying. Ss Air Intact Inherited The G1 Duralumin Air Spool It Was Born As A Sports Car So To Speak Hashireru A Public Road. Payment We accept PayPal

only. Please pay for the item within 4 days after the auction ends. Unpaid buyer will be reported to Ebay. Shipping will usually ship within. Since it is a secondhand product, there are scratches, but only those who can understand please. Maintenance was frequently done. There is no operation problem. Payment I only accept Paypal. Please make a payment by Paypal within 5 days after your purchase. Shipping Free shipping! We will ship to world wide by Economy International Shipping. We will ship your item within 10 business. International Buyers Please Note Import duties, taxes, and charges are not included in the item price or shipping cost. Please check with your country's customs office to determine what these additional costs will be prior to bidding or buying. About Us We are located in Japan. It's our pleasure to make you happy by proposing our recommend item. If you have any questions or request about items, please feel free to ask us. International Buyers Please Note Import duties, taxes, and charges are not included in the item price or shipping charges. These charges are the buyers responsibility. Please check with your country's customs office to determine. About Us We are located in Japan. It's our pleasure to make you happy by proposing our recommend item. If you have any questions or request about items, please feel free to ask us. These charges are the buyers. Sw Lure Dedicated Large Spinning Reel a—.

<http://fscl.ru/content/capitalism-ii-manual-espa-ol>